

HELLERAU – European Centre for the Arts

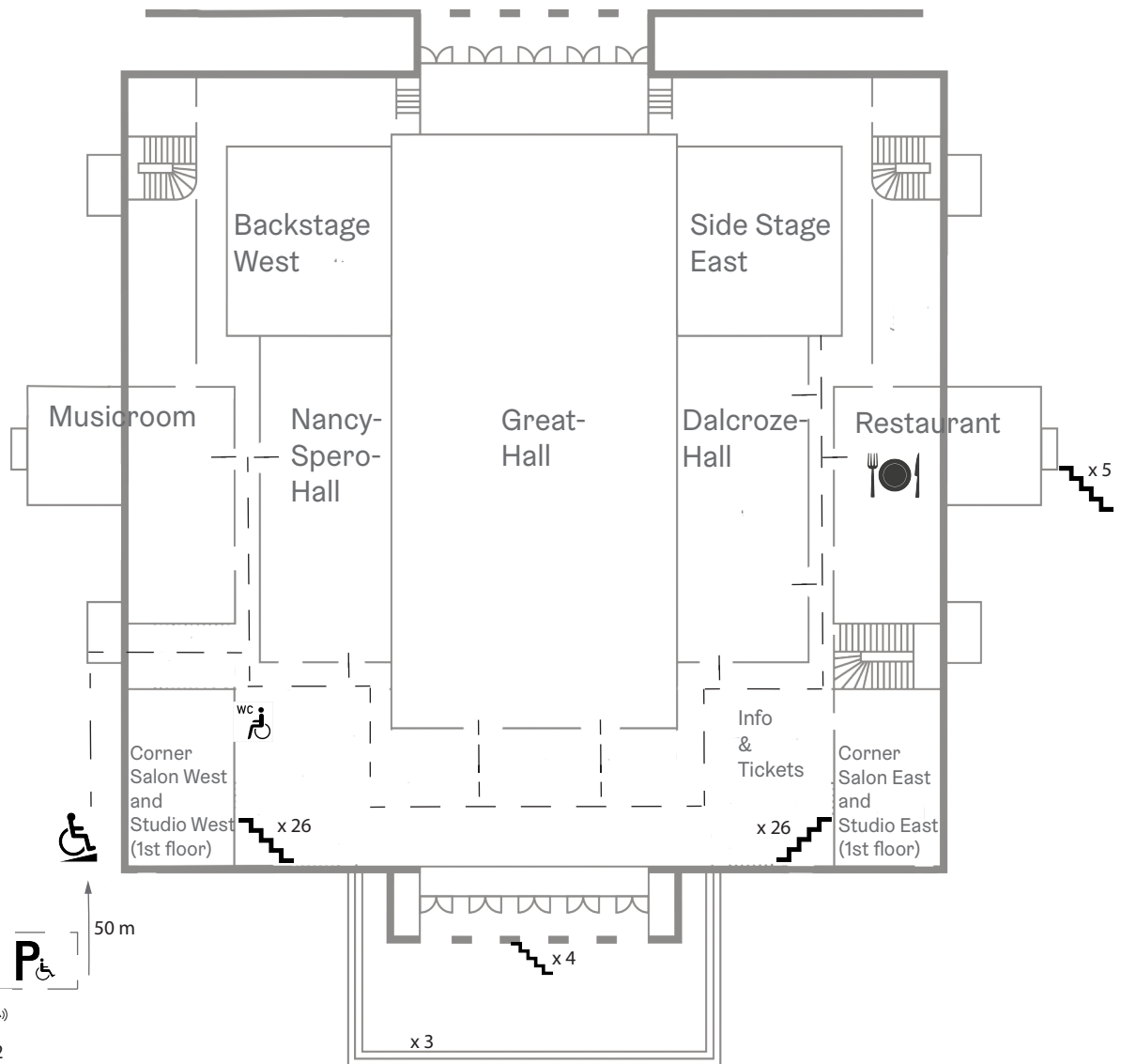

Kulturgarten

The Kulturgarten is accessible via a gravel path. The garden itself consists of a lawn. Special restrictions within the framework of an event may be found in the program.



ground floor
Visitorcentre

Mon – Sat/holidays
11 am – 6 pm
Su (05/01 - 10/31)
1 – 6 pm

ground & 1st floor
Offices

All rooms and the Kulturgarten, with the exception of the 1st floor, are wheelchair accessible via entrance on the west side of the building.

The visitorscentre can be reached by a ramp. Staff will help you. Please ring the bell.

Tram
“Festspielhaus Hellerau“
300 m (low barrier)



Tram
“Heinrich-Tessenow-Weg“
650 m (wheelchair accessible)