

# HELLERAU – European Centre for the Arts

The Kulturgarten is accessible via a gravel path. The garden itself consists of a lawn. Special restrictions within the framework of an event may be found in the program.

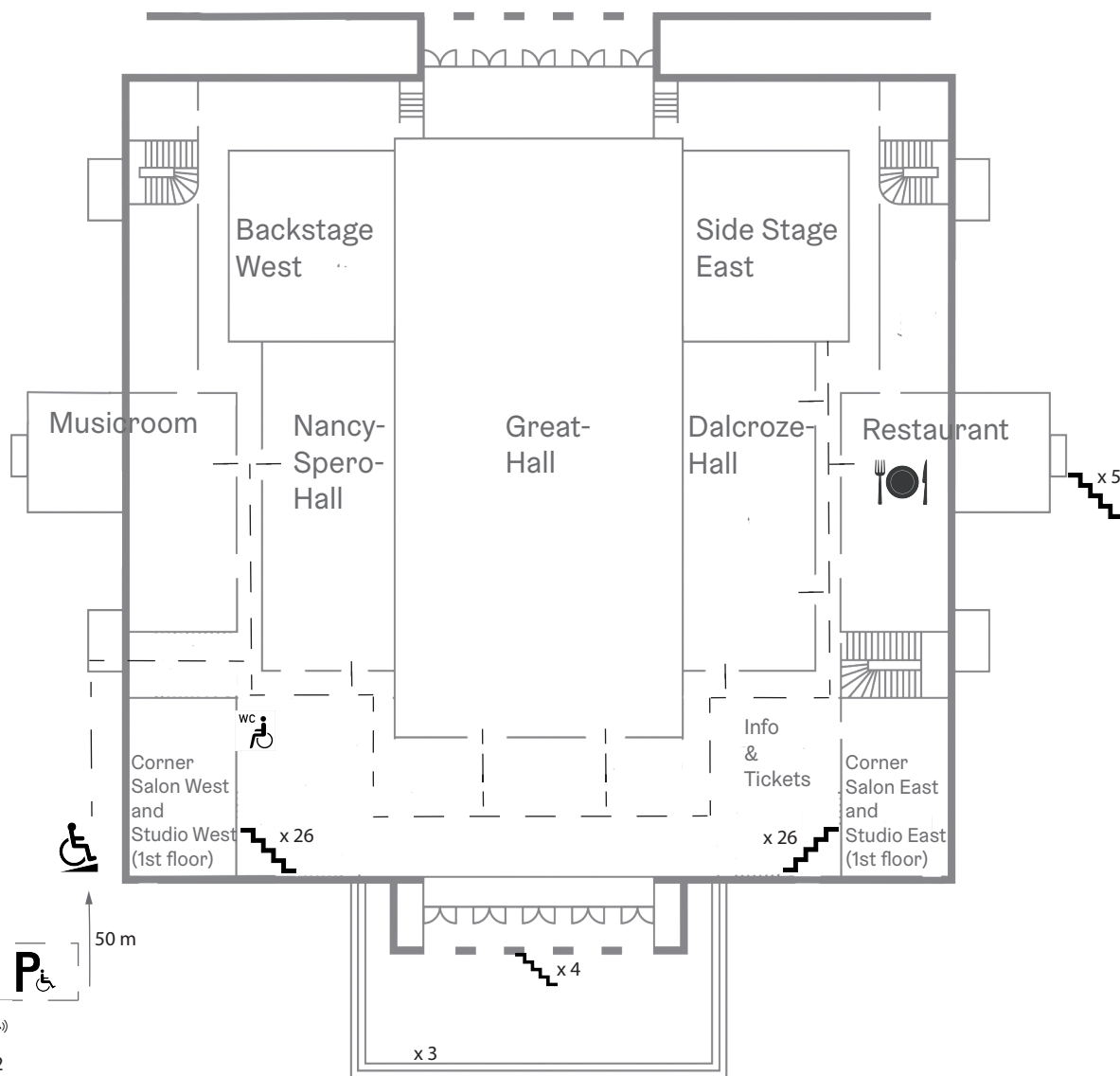

ground floor  
**Visitorcentre**

Mon – Sat/holidays  
11 am – 6 pm  
Su (05/01 - 10/31)  
1 – 6 pm

ground & 1st floor  
**Offices**

All rooms and the Kulturgarten, with the exception of the 1st floor, are wheelchair accessible via entrance on the west side of the building.

The visitorscentre can be reached by a ramp. Staff will help you. Please ring the bell.

Opening Hours Restaurant  
„Die Pastamanufaktur“

Monday to Friday  
from 12 to 2.30 pm, on event days  
additionally  
from 5 pm until  
one hour after  
the event

Tram  
„Festspielhaus Hellerau“  
300 m (low barrier)



Tram  
„Heinrich-Tessenow-Weg“  
650 m (wheelchair accessible)